

# CMR 351

SPARE PARTS LIST



**NORTON**  
SAINT-GOBAIN®

**clipper®**



## 1. SPARE PART LIST

Pos.	Code	Description	Type (*)	Quantity
1	510114590	Angle Adjustment Sleeve	S	2
2	NA	Hex Bolt M6x30	H	2
3	NA	Nut M6	H	4
4	510114591	45° Support Bracket	S	2
5	NA	Washer 10X30X3	H	4
6	510114592	Angle Adjustment Lock Knob/M10x25	S	2
7	510112848	Rear Support Post	S	1
8	NA	Nut M8	H	8
9	NA	Hex Bolt M8x30	H	6
10	510114593	Wrench Storage	S	1
11	NA	Hex Head Bolt M5x10	H	2
12	510114666	Length Stop(Long)	S	1
13	510114638	Cutting Head Travel Bumper	S	2
14	NA	Screw M5x16	H	2
15	NA	Inner Hex Bolt M6x20	H	8
16	510114594	Guide Bar	S	1
17	NA	Hex Bolt M8x25 with Flange	H	8
18	510114537	Multipurpose Wrench	S	1
19	NA	Washer 6	H	11
20	NA	Lock Washer 6	H	6
21	NA	Hex Bolt M6x16	H	9
22	510094299	Guide Rail	W	1
23	510104657	Cable & Hose Hanger	S	1
24	510114639	Plug Seat	S	1
25	510114289	Nylon Plain Washer 22x10.5x2	H	2
26	510112849	Front Support Post	S	1
27	510114679	Spring Clip	W	1
28	NA	Washer 5	H	4
29	NA	Lock Washer 5	H	1
30	NA	Hex Bolt M5x12	H	2
31	510114667	Length Stop(Short)	S	1
32	510114678	Water Collection	S	1
33	510114605	Ruler Guide	W	1
34	NA	Inner Hex Screw M8x10	H	2
35	510114640	Carry Handle	S	4
36	510114641	Carry Handle Sleeve	S	4
37	NA	Hex Bolt M8x25	H	3
38	NA	Lock Washer 8	H	6
39	510114642	Sleeve	S	2
40	510114296	Shaft	S	2
41	NA	Screw M5x10	H	4

42	510114592	Starlike Knob M10x25	S	10
43	510114277	Main Metal Frame	S	1
44	510114291	Cutting Table A	S	1
45	510114682	Spring Clip	S	2
46	510114292	Cutting Table B	S	1
47	510114290	Drain Plug	S	2
48	510114538	Screw M8x25 with Spring & Ball	H	4
49	510114643	Plastic Protection Cap	W	1
50	NA	Hex Bolt M4x8	H	4
51	510114714	Cutting Head Position Bracket	S	1
52	510114293	Starlike Knob M6x35	S	1
53	510112850	Push Handle	S	1
54	510114297	Rubber Handle	S	3
55	510114354	Starlike Knob M6x10	S	2
56	NA	Hex Bolt M10x180	H	1
57	NA	Washer 10	H	4
58	510114715	Adjustment Locking Handle	S	1
59	510114298	Load Spring	S	1
60	510114716	Nylon lock Nut M10	H	1
61	NA	Hex Bolt M10x20	H	1
62	NA	Nut M10	H	1
63	NA	Screw M4x45	H	4
64	310370255	Switch	W	1
65	NA	Washer 8X30X3	H	5
66	NA	Hex Bolt M8x20	H	2
67	NA	Washer 8	H	8
68	510113184	Motor Bracket	S	1
69	NA	Diamond Blade	H	1
70	NA	Flat Washer 5X15	H	1
71	NA	Nut M5	H	1
72	510114300	Splash Guard	W	1
73	510114345	Inner Blade Guard	S	1
74	510114346	Ouer Blade Guard	S	1
75	510114278	Hose Ø 18X2.5 L=3.4m	W	1
76	510114356	Water Valve	W	1
77	510114595	Adapter	W	1
78	510114597	"O" Ring 16X2.4	W	1
79	510114596	"Y" Adapter	W	1
80	510114285	Hose Ø 8X1.5 L=3.2m	W	1
81	510114285	Hose Ø 8X1.5 L=3.2m	W	1
82	510114286	Straight Leg	S	4
83	510103596	Rubber Pad	W	4
84	510114539	Butterfly Screw M6x12	W	2
85	510114677	Plastic Hanlde	S	1
86	510103610	Guide A Cut	W	1

87	NA	Screw M6x20	H	2
88	310064856	Guide A Cut 45°	W	1
90	310377102	Water Pump	W	1
C	510094300	Cutting Head Carriage Bracket Complete Set	S	1
C-1	NA	Nut M8	H	8
C-2	510114672	Adjustment Guide Wheel Shaft(Short)	S	4
C-3	510114357	Bearing 6201-2RS	W	17
C-4	510114717	Sleeve	S	4
C-5	NA	Inner Hex Screw M8x45	H	6
C-6	NA	Thin Nut M8	H	6
C-7	510114669	Rolling Wheel Shaft	S	1
C-8	NA	Washer 8	H	6
C-9	NA	Lock Washer 8	H	6
C-10	510114671	Rolling Wheel Shaft(Short)	S	3
C-11	510114673	Adjustment Guide Wheel Shaft(Long)	S	2
C-12	NA	Hex Bolt M8x115	H	2
C-13	510114675	Cutting Head Carriage Bracket	S	1
M	310047701	Motor 230V	S	1
M-1	510114540	Lock Nut / M20(Left)	S	1
M-2	310048258	Outer Flange	S	1
M-3	310048257	Inner Flange	S	1
M-4	510114342	Key 5x10	S	1
M-5	510114343	Shaft Seal $\Phi 47 \times \Phi 25 \times 12$	W	1
M-6	NA	Screw M5x25	H	10
M-7	NA	Split Lock Washer 5	H	12
M-8	NA	Flat Washer 5	H	10
M-9	510114358	Front Cover	S	1
M-10	510114287	Bearing 6205	S	1
M-11	510114359	Rotor	S	1
M-12	510114288	Bearing 6202	S	1
M-13	510114360	Stator	S	1
M-14	510114361	Motor Housing	S	1
M-15	510114362	End Cover	S	1
M-16	310064557	Fan	S	1
M-17	310060598	Fan Cover	S	1
M-18	510114386	Cord Grip(PG9)	W	1
M-19	510114387	Cord Grip(PG13.5)	W	1
M-20	NA	Screw M5x16	H	4
M-21	510114604	Capacitor Cover	S	1
M-22	510114598	Rubber Seal	S	1
M-23	310370870	Capacitor	S	1
M-24	510114523	Capacitor Retainer	S	2
M-25	NA	Screw M4x10	H	1
M-26	NA	Flat Washer 4	H	1
M-28	510114676	Wiring Block	S	1

S	310384549	Side Extension Table Complete Set	S	1
S-1	NA	Hex Bolt M8x16	H	2
S-2	NA	Split Lock Washer 8	H	2
S-3	NA	Flat Washer 8	H	2
S-4	510114718	Ruler Guide on Side Extension Table	W	1
S-5	510114539	Butterfly Screw M6x12	W	2
S-6	NA	Flat Washer 6	H	2
S-7	510114599	Mounting Plate	S	1
S-8	510114668	Side Extension Table	S	1

(\*): S = Spare part, W = Wear part, H = Hardware, NA = Not Available

NA = Not Available / this component is not available as wear part.

H : Not supplied alone / this component is a component standard which you can easily find at all the standard retailers of parts. All the standard components of assembly have a quality grade 8.8. We recommend to don't use a quality grade lower than 8.8.

W : Wear parts are worn out through normal use of the machine. The use period depends a lot on the intensity of work of the machine.

Wear parts must be serviced, used and eventually changed following the indications of the manufacturer. Any wear due to normal use of the machine will not be considered as a case of warranty.

S : Genuine CLIPPER replacement parts should always be used.

## 2. EXPLODED VIEW

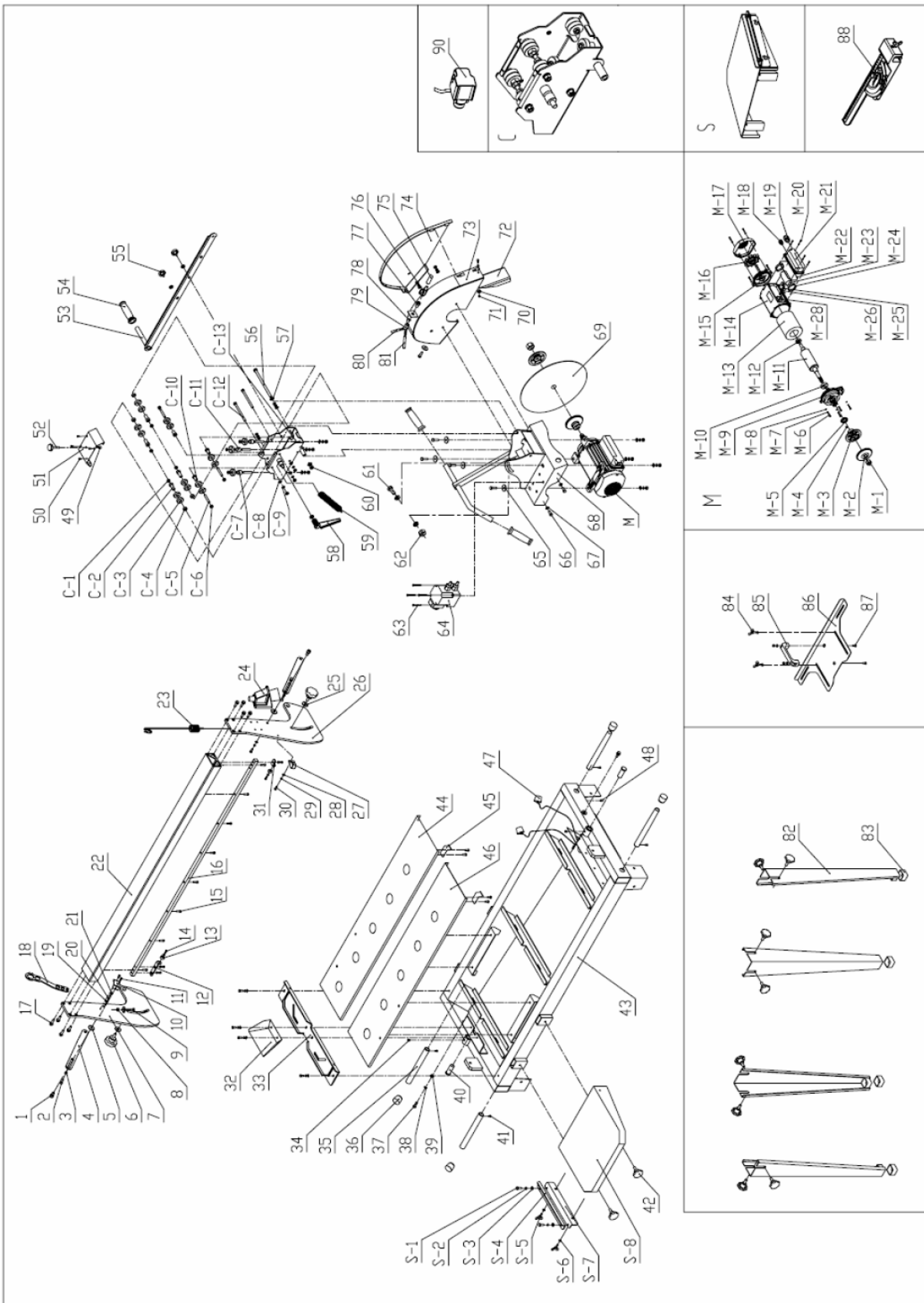

[www.construction.norton.eu](http://www.construction.norton.eu)

**Saint-Gobain Abrasives**

190, Bd. J. F. Kennedy  
L-4930 BASCHARAGE  
LUXEMBOURG

Tel: ++352 50401-1

Fax: ++352 501633

e-mail: [sales.nlx@saint-gobain.com](mailto:sales.nlx@saint-gobain.com)